



HANWHA STL38H AUTOMATIC SWISS LATHE

Call for pricing

[1-815-597-5341](tel:1-815-597-5341)

Turret-Type CNC Automatic Lathe

- Adaptable for various tools - M8 rigid tapping and Y3-Axis that accommodates up to 40 tools
 - Improved performance - high-performance motor (23kW) and Siemens 840D
- Improved durability - greater durability and safety with an enhanced slide cover structure and machining methods

SKU: N/A

Category: [New Machines](#)

GALLERY IMAGES

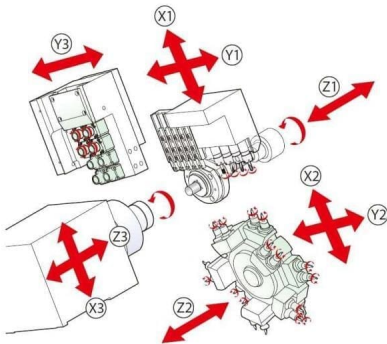

Model	STL32/38	
	-	Y3
NC	Siemens 840D	
Max. machining diameter	Ø32/38	
Z1 Stroke (mm)	320	
Main spindle	rpm	6,500
	kW	23
OD tool	No. of tools	5 (□ 16mm)
	No. of tools	4 (ER20M)
Cross drill	rpm	6,000
	kW	1.07
Turret unit	No. of unit	1 Unit (10 Station)
	No. of tools	max. 30 (□ 20, ER20)
	Tool type	VDI 30 (Option : BMT 45)
Sub spindle	rpm	6,500
	kW	23
Back tool	No. of tools	3 (ER20M) (3 Fixed)
	rpm	6,000
	kW	1.07
Machine size (L x W x H) (mm)	3,130 x 1,860 x 1,780	
Weight (kg)	4,400	4,500
Power Consumption (Cable size)	40KVA, 26.7KW (VCTF 16SQ x 4C)	
Air Flow rate (Liter/Min)	20 ~ 30 (Hydraulic device capacity : 30L)	

ADDITIONAL INFORMATION

NC	Siemens 840D
Max machining diameter	Ø38mm
Main Spindle Max Speed	7,000 rpm
Main Spindle Motor Power	23 kW
Sub Spindle Max Speed	7,000 rpm
Sub Spindle Motor Power	23 kW
Cross Drill Max Speed	6,000 rpm
Cross Drill Motor Power	1.07 kW
Weight	4,400 kg
Machine Size (L x W x H)	2,800 x 2,150 x 1790

