



## HANWHA XP12S AUTOMATIC SWISS LATHE

Call for pricing

[1-815-597-5341](tel:1-815-597-5341)

### Cost-Effective, High-Productivity CNC Automatic Lathe

- Economical structure - economical model with optimized design and space utilization
- Enhanced productivity - less C/T and higher productivity with high-precision machining

---

**SKU:** N/A

**Categories:** [New Machines](#)

## GALLERY IMAGES

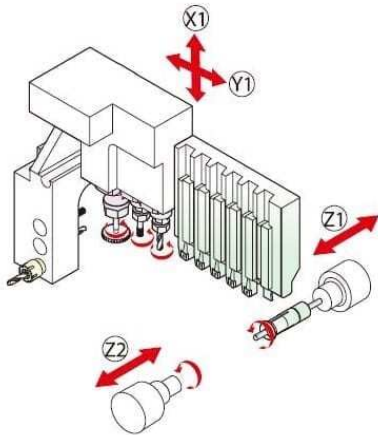

Model	XP12S	XP16S
NC	Hanwha Fanuc-i	
Max. machining diameter	Ø12	Ø16
Z1 Stroke (mm)	140	
Main spindle		
rpm	12,000	
kW	2.2/5.5	
OD tool	No. of tools	6 (□12mm)
Front tool	No. of tools	3 (ER11, Ø20)
Cross drill	No. of tools	3 (ER11 x 2, ER16 x 1)
rpm	6,000	
Sub spindle		
rpm	8,000	
kW	0.5	
Machine size (L x W x H) (mm)	1,650 x 1,090 x 1,640	
Weight (kg)	1,800	
Power Consumption (Cable size)	10kVA, 6.7kW (VCTF 10SQ x 4C)	
Air Flow rate (Liter/Min)	120 ~ 150	

## ADDITIONAL INFORMATION

<b>NC</b>	Hanwha Fanuc-i
<b>Max machining diameter</b>	Ø12 mm
<b>Main Spindle Max Speed</b>	12,000 rpm
<b>Main Spindle Motor Power</b>	2.2 / 5.5 kW
<b>Sub Spindle Max Speed</b>	8,000 rpm
<b>Sub Spindle Motor Power</b>	0.55 kW / 1.1 kW
<b>Cross Drill Max Speed</b>	6,000 rpm
<b>Cross Drill Motor Power</b>	0.5 kW

<b>Weight</b>	1,800 kg
<b>Machine Size (L x W x H)</b>	1,800 x 1,090 x 1,640